

GROUP:	5C
FORM:	125-127AE
FILE:	Alternator Parts List Section
DATE:	September, 1988

MODEL	VOLTS	AMPS
Various See Chart		

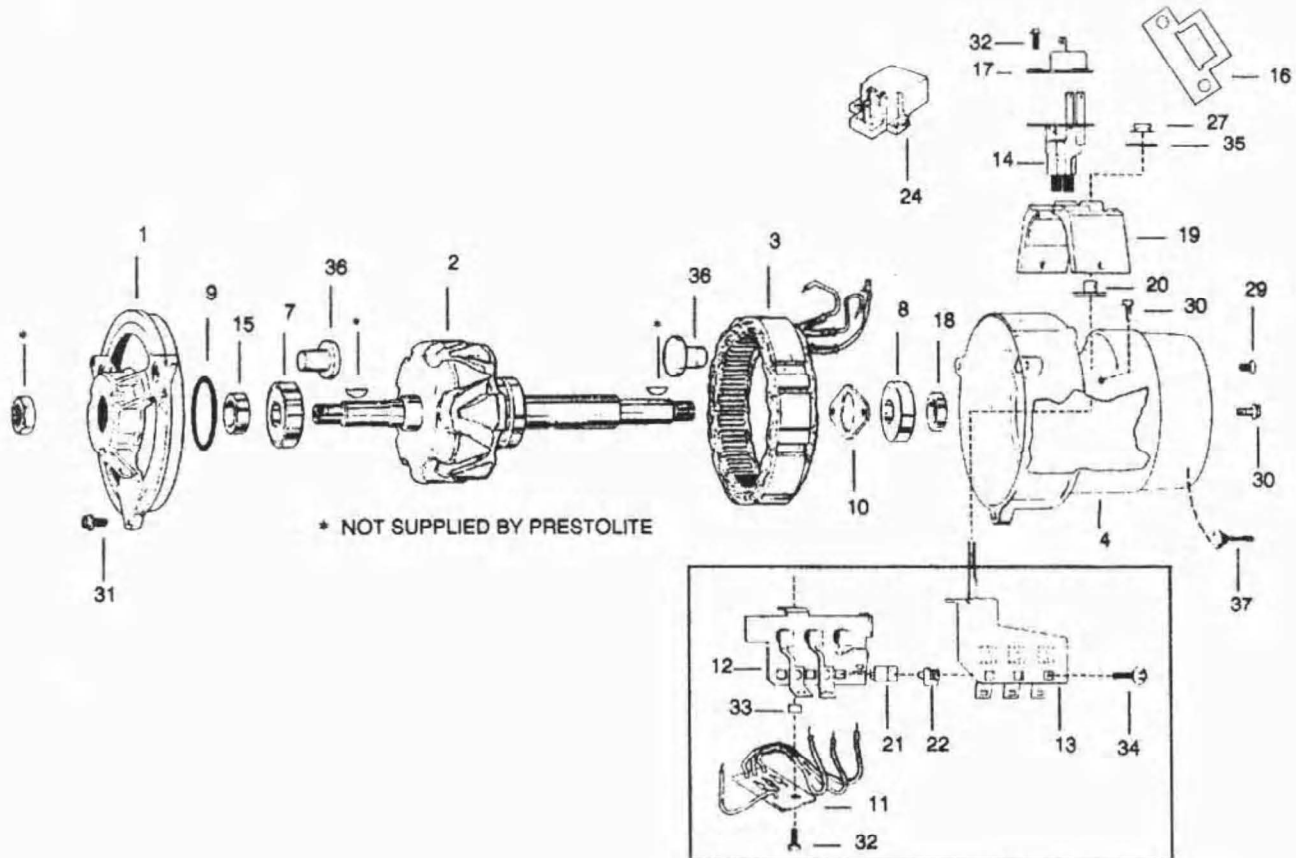

MODEL NO.	SALES NO.	1 HSNG FRONT	2 ROTOR ASSEM	3 STATOR ASSEM	4 HSNG MAIN	5 FAN	6 PULLEY	7 BRNG FRONT	8 BRNG REAR	9 FR.BRNG RET.	10 R.BRNG RET.	11 FIELD. DIODE	12 DIODE REC,NEG
8AL2034K		114-141	112-41	113-36	114-142			111-21	111-65	111-64	111-66	101-120	101-121
8AL2034KA		114-141	112-41	113-36	114-142			111-21	111-65	111-64	111-66	101-128	101-121
8AL2057K	110-762	114-141	112-41	113-36	114-142			111-21	111-65	111-64	111-66	101-120	101-121
8AL2072K		114-141	112-41	113-36	114-112			111-21	111-65	111-64	111-66	101-120	101-121
8AR2047K		114-141	112-41	113-36	114-142			111-21	111-65	111-64	111-66	101-128	101-121
8AR2064K	110-761	114-141	112-41	113-36	114-142			111-21	111-65	111-64	111-66	101-128	101-121

Important: The information contained in this bulletin is intended for use by trained, professional technicians who have the proper tools, equipment, and training to perform the required maintenance described above. This information is NOT intended for 'do-it-yourselfers', and you should not assume that this information applies to your equipment. If you have any questions regarding this information please visit our website at [www.prestolite.com](http://www.prestolite.com), or contact our technical service department at:

GROUP:	5C
FORM:	125-127AE

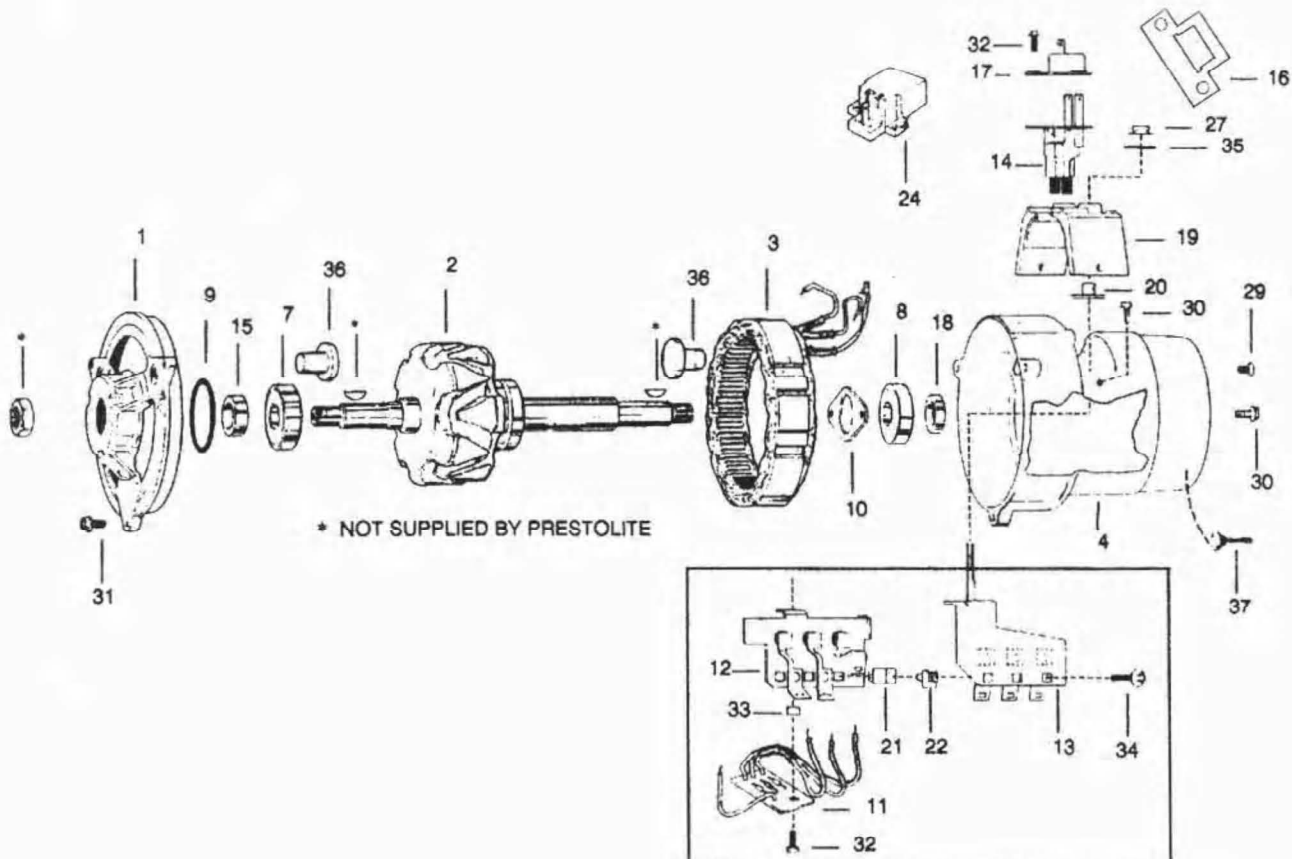

MODEL NO.	SALES NO.	13 DIODE REC.POS	14 BRUSH ASSEM	15 FR. PUL SPACER	16 BR CVR GASKET	17 BR CVR HOLDER	18 SPACER REAR	19 COVER	20 SLEEVE SPACER	21 INSUL NYLON	22 INSUL NYLON	23	24 VOLT REG.
8AL2034K		101-122	103-36	120-250	103-45	103-37	120-251	114-143	115-47	115-48	115-49		
8AL2034KA		101-122	103-41	120-250	103-45		120-251	114-143	115-47	115-48	115-49		105-762
8AL2057K	110-762	101-122	103-36	120-250	103-45	103-37	120-251	114-143	115-47	115-48	115-49		
8AL2072K		101-122	103-36	120-250	103-45	103-37	120-251	114-143	115-47	115-48	115-49		
8AR2047K		101-122	103-41	120-250	103-45		120-251	114-143	115-47	115-48	115-49		105-762
8AR2084K	110-761	101-122	103-41	120-250	103-45		120-251	114-143	115-47	115-48	115-49		105-762

Important: The information contained in this bulletin is intended for use by trained, professional technicians who have the proper tools, equipment, and training to perform the required maintenance described above. This information is NOT intended for 'do-it-yourselfers', and you should not assume that this information applies to your equipment. If you have any questions regarding this information please visit our website at [www.prestolite.com](http://www.prestolite.com), or contact our technical service department at:





GROUP:	5C
FORM:	125-127AE

[illegible]

Important: The information contained in this bulletin is intended for use by trained, professional technicians who have the proper tools, equipment, and training to perform the required maintenance described above. This information is NOT intended for 'do-it-yourselfers', and you should not assume that this information applies to your equipment. If you have any questions regarding this information please visit our website at [www.prestolite.com](http://www.prestolite.com), or contact our technical service department at: